



▼ Shown: FH604, FR400, A630 disassembled, C604, AH604, AR400



Quick Connection of Hydraulic Lines



Thread Sealer
To seal NPTF threads use one of the new anaerobic thread sealers or Teflon® paste. When using Teflon® tape, apply the tape one thread back from the end of a fitting to prevent it from entering the hydraulic system.



WARNING!
Couplers should be pressurized only when completely connected, and should not be coupled or uncoupled when pressurized.
More safety instructions in our “Yellow Pages”.

Page: 400



Torque Wrench Couplers
S-, W-, RSL-, DSX- and HMT-Series Torque Wrenches require 1/4" spin-on couplers and THQ hoses.

Page: 239

▼ With the use of Enerpac High Flow Couplers, hoses are easily installed for multiple hydraulic line connections in this 34 points PLC-controlled lifting system.



3/8" High Flow Couplers

- Standard equipment on most Enerpac cylinders
- Recommended for use on all Enerpac pumps and cylinders where space and porting permits
- Include “2-in-1” dust cap for use on male and female coupler halves

3/8" High Flow “Flush-face” Couplers

- Featuring “Push-to-connect” operation, to guarantee good connection every time
- Flush-face, zero-leak operation for minimal spillage
- HTMA* recognized for safety and performance

3/8" Regular Spee-D-Coupler®

- For medium-duty applications; for use with hand pumps
- Includes female steel dust cap

1/4" Regular Coupler

- For use with small cylinders and hand pumps
- Includes female steel dust cap

1/4" Spin-on Torque Wrench Couplers

- For use with 10,000 psi S-, W-, RSL-, DSX- and HMT-Series torque wrenches, THQ-Series hoses and 10,000 psi torque wrench pumps

* Hydraulic Tool Manufacturers Association

Hydraulic Couplers



CT604 Safety Tool

Use the Enerpac CT604 to relieve hydraulic back pressure by safely bleeding the hydraulic coupler. Minimize injuries from projectile parts and under-skin hydraulic fluid injections by

eliminating unsafe coupler bleeding practices. The CT604 is Enerpac-engineering safe for use at 10,000 psi (700 bar).

NOTE: C-Series only.

A, C, F, T Series



Maximum Flow Capacity:

462 - 2,500 in³/min.

Thread:

1/4" and 3/8" NPTF

Maximum Operating Pressure:

10,000 psi

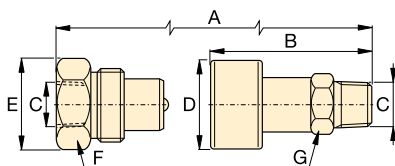

C604

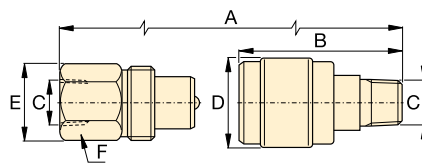

A604
A630

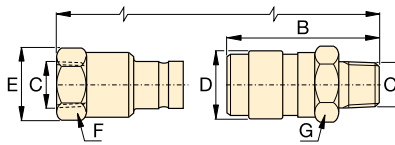

F604

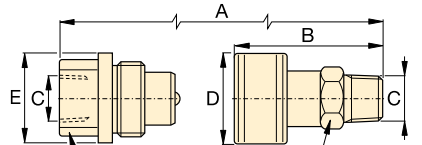

T630

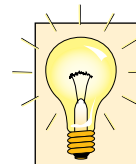

Metal Dust Caps

Steel dust caps are available for the C604 series couplers. Order model number: **CD411M** for female half **CD415M** for male half

| Maximum Flow Capacity (in ³ /min) | Coupler Type | Model Numbers | | | Dimensions (in) | | | | | | | Dust Cap(s) |
|--|------------------------------------|---------------|-------------|-----------|-----------------|------|-----------|------|------|------|------|---------------------------|
| | | Complete Set | Female Half | Male Half | A* | B | C | D | E | F | G | |
| 2,100 | 10,000 psi High Flow Coupler | C604 | CR400 | CH604 | 3.26 | 2.87 | 3/8" NPTF | 1.38 | 1.38 | 1.25 | 1.00 | (2x) CD411 Included |
| | | | | | | | | | | | | |
| 2,500 | 10,000 psi Flush-face coupler | F604 | FR400 | FH604 | 4.36 | 2.85 | 3/8" NPTF | 1.23 | 1.23 | 1.06 | 1.12 | - |
| | | | | | | | | | | | | |
| 462 | 10,000 psi Regular Spee-D-Coupler® | A604 | AR400 | AH604 | 3.09 | 2.53 | 3/8" NPTF | 1.12 | 0.94 | 0.94 | 0.73 | Z410 female only Included |
| | | | | | | | | | | | | |
| 462 | 10,000 psi Regular Coupler | A630 | AR630 | AH630 | 2.61 | 1.72 | 1/4" NPTF | 0.87 | 0.81 | 0.75 | 0.57 | Z640 female only Included |
| | | | | | | | | | | | | |
| 695 | 10,000 psi Spin-on Coupler | T630 | TR630 | TH630 | 2.87 | 2.36 | 1/4" NPTF | 1.14 | 1.14 | 0.74 | 0.82 | - |
| | | | | | | | | | | | | |

* Value A is total length when male and female halves are connected.