

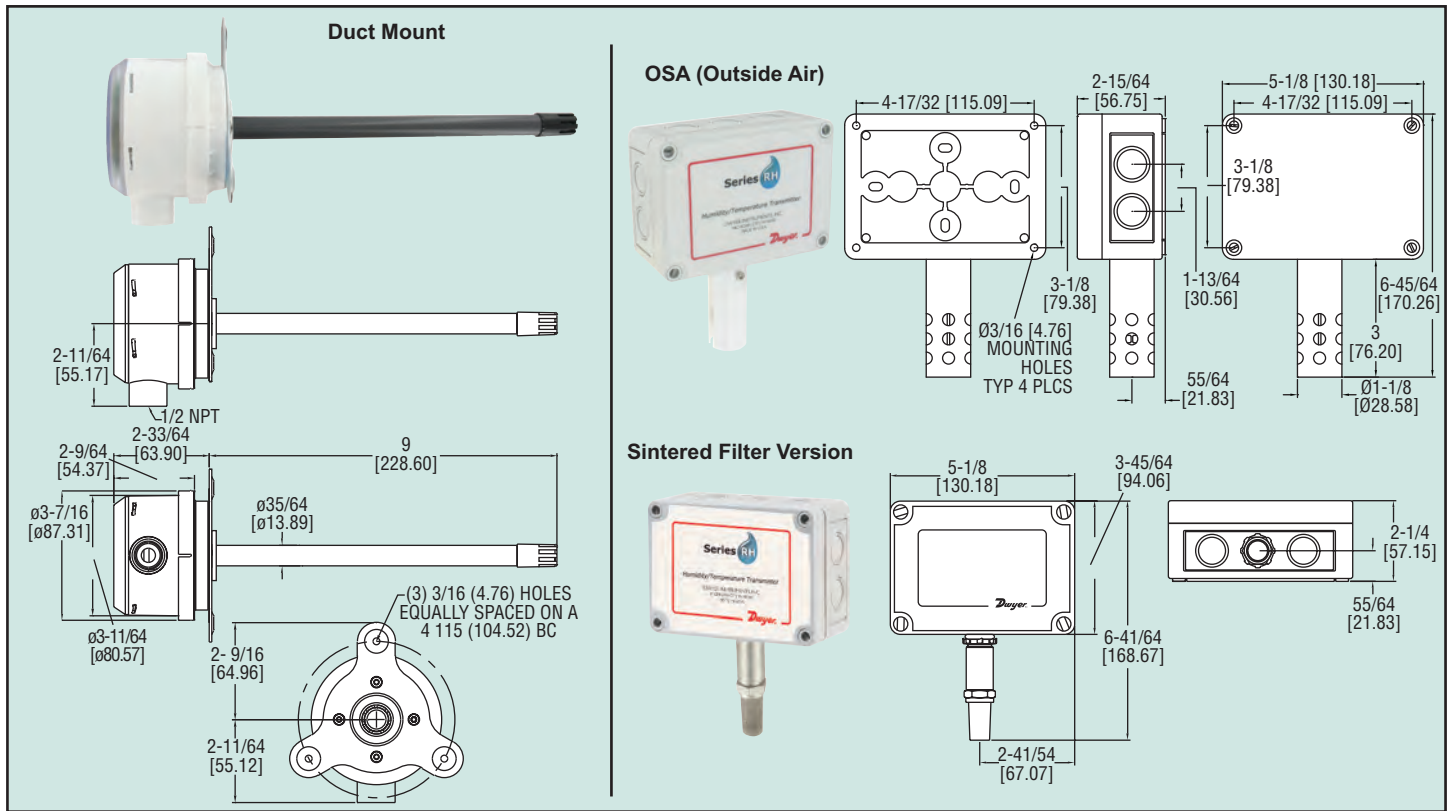

Series
RHP

Humidity/Temperature Transmitter

Passive Temperature Outputs, Sintered Filter Options



The Series RHP Temperature and Humidity Transmitter combine the voltage or current humidity transmitter output with a passive temperature thermistor or RTD output. The polymer capacitance humidity sensor is not affected by condensation, fog, high humidity, or contaminants. The humidity sensors are available with 2% or 3% accuracies. Duct mounted transmitters are available with an optional two-line alpha numeric LCD display. The Series RHP is available with interchangeable filter options as well as replaceable sensors.

Example	RHP	2	D	1	A	LCD	RHP-2D1A-LCD
Series	RHP						RH/Passive Temperature Sensor Transmitter
Accuracy		2 3					2% Accuracy 3% Accuracy
Housing Type			D F O S R				Duct Mount w/Plastic Tip Duct Mount w/Sintered Filter OSA (Outside Air) OSA w/Sintered Filter* Radiation Shield
RH Output				1 2 3			4-20mA 0-10V 0-5V
Temperature Sensor				0 1 2 3 A B C D E F			None 4-20mA 0-10 VDC 0-5V 10K @ 25°C Thermistor Dwyer Curve A 10K @ 25°C Thermistor Dwyer Curve B 3K @ 25°C Thermistor Dwyer Curve C 100Ω RTD DIN 385 1KΩ RTD DIN 385 20KΩ @ 25°C Thermistor
Option						LCD	LCD Display

SPECIFICATIONS

Relative Humidity Range: 0 to 100% RH.

Temperature Range: -40 to 140°F (-40 to 60°C).

Accuracy, RH: Model RHP-2XXX ±2% 10-90% RH @ 25°C; Model RHP-3XXX ±3% 20-80% RH @ 25°C.

Accuracy, Thermistor Temp Sensor: ±0.22°C @ 25°C (±0.4°F @ 77°F).

Accuracy, RTD Temp Sensor: DIN Class B; ±0.3°C @ 0°C (±0.54°F @ 32°F).

Hysteresis: ±1%.

Repeatability: ±0.1% typical.

Temperature Limits: -40 to 140°F (-40 to 60°C).

Storage Temperature: -40 to 176°F (-40 to 80°C).

Compensated Temperature Range: -4 to 140°F (-20 to 60°C).

4-20 mA Loop Powered Models: Power requirements: 10-35 VDC; Output signal: 4-20 mA.

0-5/10V Output Models: Power requirements: 15-35 VDC or 15-29 VAC; Output signal: 0-10V @ 5 mA max.

Response Time: 15 seconds.

Electrical Connections: Removable screw terminal block.

Conduit Connection: Duct mount: 1/2" NPS; OSA: 1/2" (22.3 mm).

Drift: <1% RH/year.

RH Sensor: Capacitance polymer.

Temperature Sensor: Curves A, B, C: Thermistor; Curves D, E: Platinum RTD DIN 385.

Enclosure: Duct mount: PBT; OSA: Polycarbonate.

Enclosure Rating: NEMA 4X (IP65) for OSA mount only.

Display: Duct mount only, optional 2-line alpha numeric, 8 characters/line.

Display Resolution: RH: 0.1%; 0.1°F (0.1°C).

Weight: Duct mount: .616 lb (.3 kg); OSA: 1 lb (.45 kg).

Agency Approvals: CE.

*Model RHRS Radiation Shield is required for sintered filter OSA models.