

Pomona®

Model 3846 Adapter, Isolated Ground BNC Female To Female

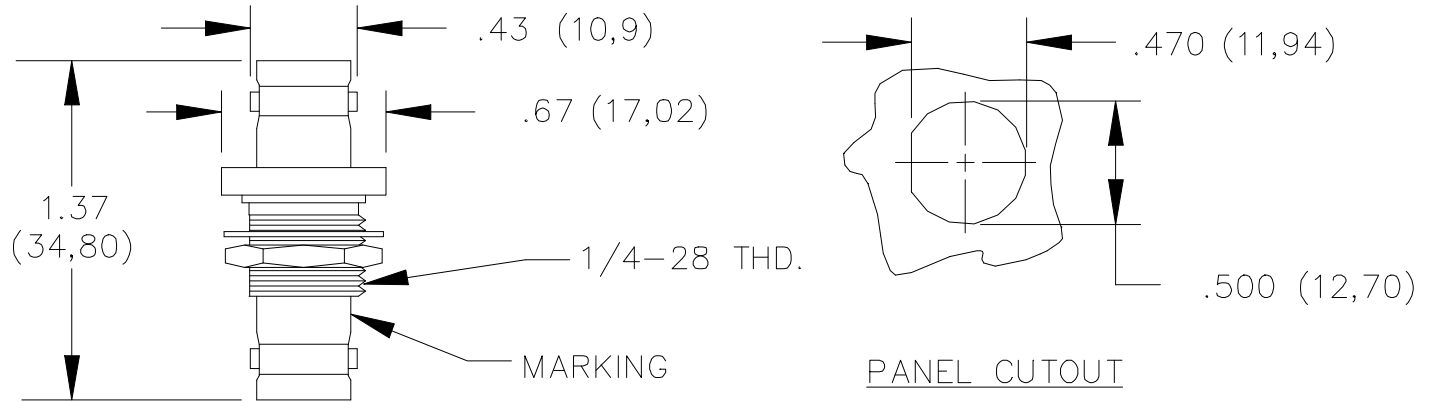

FEATURES:

- Mounts in panels up to 4.47 (.175) thick.
- BNC shell body isolated from threaded flange.

MATERIALS:

Body – Brass, Tarnish Resistant Plating, Center Contact: Gold Plated Beryllium Copper

Dielectric: PTFE

Finish: Body and Fittings – Tarnish Resistant

Center Contact – Gold Plated

Marking: “Pomona 3846”

RATINGS:

Operating Voltage: Shield/Earth: 30VAC/60VDC Max.

Inner Conductor/Shield: 500VRMS Max.

Operating Temperature: -65°C to +165°C

Nominal Impedance: 50 Ohms

ORDERING INFORMATION: Model 3846

All dimensions are in inches. Tolerances (except noted): .xx = ±.02” (.51 mm), .xxx = ± .005” (.127 mm).

All specifications are to the latest revisions. Specifications are subject to change without notice.

Registered trademarks are the property of their respective companies. Made in USA